



MID SUFFOLK DISTRICT COUNCIL
 Licensing Authority
 Endeavour House, 8 Russell Road
 IPSWICH
 Suffolk IP1 2BX
 Website: www.midsuffolk.gov.uk
 Switchboard: 0300 123 4000

Licensing Act 2003
Premises Licence Summary

MPL0372

Postal Address of Premises, or if none, Ordnance Survey Map Reference or Description

<p>The Rampant Horse Inn Coddenham Road Needham Market IPSWICH IP6 8AU</p>			
Post Town:	IPSWICH	Post Code:	IP6 8AU
Telephone Number:			

Where the licence is time limited the dates

N/A

Licensable activities authorised by the licence

- **Supply of alcohol (for consumption both ON and OFF the premises)**
- **Recorded Music (Indoors)**
- **Live Music (Indoors)**
- **Films – (Indoors)**
- **Performance of Dance (Indoors)**
- **Late Night Refreshment (Indoors)**

The times the licence authorises the carrying out of licensable activities

STANDARD TIMINGS:

(a) Supply of alcohol (for consumption both ON and OFF the premises)

Hours authorised: 09:00hrs until 00:00hrs (Monday to Thursday)
 09:00hrs until 02:00hrs (Friday and Saturday)
 09:00hrs until 23:30hrs (Sunday)

**(b) Films (Indoors)
 Plays (Indoors)**

Hours authorised: 12:00hrs until 00:00hrs (Monday to Thursday)

(c) Late Night Refreshment (Indoors)

Hours authorised: 23:00hrs until 00:00hrs (Sunday to Thursday)
 23:00hrs until 02:00hrs (Friday and Saturday)

(d) Live Music (Indoors)

Hours authorised: 09:00hrs until 21:00hrs (Monday to Thursday)
 10:00hrs until 00:00hrs (Friday and Saturday)
 10:00hrs until 23:30hrs (Sunday)

(e) Recorded Music (Indoors)

Hours authorised: 10:00hrs until 00:00hrs (Sunday to Thursday)
 10:00hrs until 02:00hrs (Friday and Saturday)

(f) Performance of Dance (Indoors)

Hours authorised: 12:00hrs until 00:00hrs (Monday to Thursday)
 12:00hrs until 02:00hrs (Friday)
 11:00hrs until 02:00hrs (Saturday)
 11:00hrs until 00:00hrs (Sunday)

NON-STANDARD TIMINGS / SEASONAL VARIATIONS:

Live Music (Indoors)

A further additional hour every Christmas Eve and Boxing Day.

On New Year's Eve, from the end of permitted hours on New Year's Eve to the start of permitted hours on the following day.

Recorded Music (Indoors), Late Night Refreshment (Indoors) and Supply of Alcohol (for consumption both ON and OFF the premises)

A further additional hour into the morning following every Friday, Saturday, Sunday and Monday for each May Bank Holiday, Spring/Whitsun Bank Holiday and every August Bank Holiday weekend.

A further additional hour into the morning following every Thursday, Friday, Saturday, Sunday and Monday for the Easter Bank Holiday Weekend.

A further additional hour every Christmas Eve and Boxing Day.

On New Year's Eve, from the end of permitted hours on New Year's Eve to the start of permitted hours on the following day.

The opening hours of the premises for the carrying out of licensable activities
STANDARD TIMINGS:

Hours authorised: 07:00hrs until 00:30hrs (Sunday to Thursday)
07:00hrs until 02:30hrs (Friday and Saturday)

NON-STANDARD TIMINGS / SEASONAL VARIATIONS:

A further additional hour into the morning following every Friday, Saturday, Sunday and Monday for each May Bank Holiday, Spring/Whitsun Bank Holiday and every August Bank Holiday weekend.

A further additional hour into the morning following every Thursday, Friday, Saturday, Sunday and Monday for the Easter Bank Holiday Weekend.

A further additional hour every Christmas Eve and Boxing Day.

On New Year's Eve, from the end of permitted hours on New Year's Eve to the start of permitted hours on the following day.

Where the licence authorises supplies of alcohol whether these are on and/ or off supplies

Supply of alcohol for consumption both ON and OFF the premises

Name, (registered) address of holder of premises licence

The Rampant Horse Inn Ltd

Coddenham Road
Needham Market
IPSWICH
IP6 8AU

Registered number of holder, for example company number, charity number (where applicable)

09920014

Name of designated premises supervisor where the premises licence authorises for the supply of alcohol

Alison Wyartt

State whether access to the premises by children is restricted or prohibited

Conditions 2.11 to 2.14 in Annex 2 of the premises licence



MID SUFFOLK DISTRICT COUNCIL
Licensing Authority
Endeavour House, 8 Russell Road
IPSWICH
Suffolk IP1 2BX
Website: www.midsuffolk.gov.uk
Switchboard: 0300 123 4000

Licensing Act 2003 Premises Licence

MPL0372

Part 1 - Premises Details

Postal address of premises, or if none, ordnance survey map reference or description

The Rampant Horse Inn
Coddendam Road
Needham Market
IPSWICH
IP6 8AU

Post Town: IPSWICH Post Code: IP6 8AU

Telephone number:

Where the licence is time limited the dates

N/A

Licensable activities authorised by the licence

- Supply of alcohol (for consumption both ON and OFF the premises)
- Recorded Music (Indoors)
- Live Music (Indoors)
- Films – (Indoors)
- Performance of Dance (Indoors)
- Late Night Refreshment (Indoors)

The times the licence authorises the carrying out of licensable activities

STANDARD TIMINGS:

(b) Supply of alcohol (for consumption both ON and OFF the premises)

Hours authorised: 09:00hrs until 00:00hrs (Monday to Thursday)
 09:00hrs until 02:00hrs (Friday and Saturday)
 09:00hrs until 23:30hrs (Sunday)

(b) Films (Indoors) Plays (Indoors)

Hours authorised: 12:00hrs until 00:00hrs (Monday to Thursday)

(c) Late Night Refreshment (Indoors)

Hours authorised: 23:00hrs until 00:00hrs (Sunday to Thursday)
 23:00hrs until 02:00hrs (Friday and Saturday)

(d) Live Music (Indoors)

Hours authorised: 09:00hrs until 21:00hrs (Monday to Thursday)
 10:00hrs until 00:00hrs (Friday and Saturday)
 10:00hrs until 23:30hrs (Sunday)

(e) Recorded Music (Indoors)

Hours authorised: 10:00hrs until 00:00hrs (Sunday to Thursday)
 10:00hrs until 02:00hrs (Friday and Saturday)

(f) Performance of Dance (Indoors)

Hours authorised: 12:00hrs until 00:00hrs (Monday to Thursday)
 12:00hrs until 02:00hrs (Friday)
 11:00hrs until 02:00hrs (Saturday)
 11:00hrs until 00:00hrs (Sunday)

NON-STANDARD TIMINGS / SEASONAL VARIATIONS:

Live Music (Indoors)

A further additional hour every Christmas Eve and Boxing Day.

On New Year's Eve, from the end of permitted hours on New Year's Eve to the start of permitted hours on the following day.

Recorded Music (Indoors), Late Night Refreshment (Indoors) and Supply of Alcohol (for consumption both ON and OFF the premises)

A further additional hour into the morning following every Friday, Saturday, Sunday and Monday for each May Bank Holiday, Spring/Whitsun Bank Holiday and every August Bank Holiday weekend.

A further additional hour into the morning following every Thursday, Friday, Saturday, Sunday and Monday for the Easter Bank Holiday Weekend.

A further additional hour every Christmas Eve and Boxing Day.

On New Year's Eve, from the end of permitted hours on New Year's Eve to the start of permitted hours on the following day.

The opening hours of the premises for the carrying out of licensable activities

STANDARD TIMINGS:

Hours authorised: 07:00hrs until 00:30hrs (Sunday to Thursday)
07:00hrs until 02:30hrs (Friday and Saturday)

NON-STANDARD TIMINGS / SEASONAL VARIATIONS:

A further additional hour into the morning following every Friday, Saturday, Sunday and Monday for each May Bank Holiday, Spring/Whitsun Bank Holiday and every August Bank Holiday weekend.

A further additional hour into the morning following every Thursday, Friday, Saturday, Sunday and Monday for the Easter Bank Holiday Weekend.

A further additional hour every Christmas Eve and Boxing Day.

On New Year's Eve, from the end of permitted hours on New Year's Eve to the start of permitted hours on the following day.

Where the licence authorises supplies of alcohol whether these are on and/ or off supplies

Supply of alcohol for consumption both ON and OFF the premises

Part 2

Name, (registered) address, telephone number and email (where relevant) of holder of premises licence

The Rampant Horse Inn Ltd
Coddenham Road
Needham Market
IPSWICH
IP6 8AU

Registered number of holder, for example company number, charity number (where applicable)

09920014

Name, address and telephone number of designated premises supervisor where the premises licence authorises for the supply of alcohol

Alison Wyartt

Personal licence number and issuing authority of personal licence held by designated premises supervisor where the premises licence authorises for the supply of alcohol

Personal Licence number: MPA1217
Issued by: MID SUFFOLK DISTRICT COUNCIL



**CONDITIONS ATTACHED TO THE ISSUE OF:
PREMISES LICENCE No: MPL0372 – The Rampant Horse Inn – Needham Market**

ANNEX 1 - MANDATORY CONDITIONS

The following conditions in Annex 1 are mandatory under the provisions of the Licensing Act 2003:

- 1.1 No supply of alcohol may be made under the premises licence:
- (a) At any time when there is no designated premises supervisor in respect of the premises licence;
or
 - (b) At any time when the designated premises supervisor does not hold a personal licence or his/her personal licence is suspended.
- 1.2 Every sale or supply of alcohol under the premises licence must be made or authorised by a person who holds a personal licence.
- 1.3
- (a) The premises licence holder or club premises certificate holder must ensure that an age verification policy is adopted in respect of the premises in relation to the sale or supply of alcohol.
 - (b) The designated premises supervisor in relation to the premises licence must ensure that the supply of alcohol at the premises is carried on in accordance with the age verification policy.
 - (c) The policy must require individuals who appear to the responsible person to be under 18 years of age (or such older age as may be specified in the policy) to produce on request, before being served alcohol, identification bearing their photograph, date of birth and either –
 - (i) a holographic mark, or
 - (ii) an ultraviolet feature.
- 1.4 The relevant person (“relevant person” means the holder of the premises licence, the designated premises supervisor (if any) in respect of such a licence, the personal licence holder who makes or authorises a supply of alcohol under such a licence, or any member or officer of a club present on the premises in a capacity which enables the member or officer to prevent the supply in question) shall ensure that no alcohol is sold or supplied for consumption on or off the premises for a price which is less than the permitted price.

For the purposes of this condition “duty” is to be construed in accordance with the Alcoholic Liquor Duties Act 1979, “permitted price” is the price found by applying the formula -

$$P = D + (D \times V)$$

Where - (i) **P** is the permitted price; (ii) **D** is the rate of duty chargeable in relation to the alcohol as if the duty were charged on the date of the sale or supply of the alcohol; and (iii) **V** is the rate of value added tax chargeable in relation to the alcohol as if the value added tax were charged on the date of the sale or supply of the alcohol; [“value added tax” means value added tax charged in accordance with the Value Added Tax Act 1994]

Where the permitted price would not be a whole number of pennies, the permitted price shall be taken to be the price rounded up to the nearest penny.

Where the permitted price on a day (“the first day”) would be different from the permitted price on the next day (“the second day”) as a result of a change to the rate of duty or value added tax.

APPENDIX C

The permitted price which would apply on the first day applies to sales or supplies of alcohol which take place before the expiry of the period of 14 days beginning on the second day.

- 1.5 The responsible person must ensure that free potable water is provided on request to customers where it is reasonably available.
- 1.6 The responsible person must ensure that –
- (a) where any of the following alcoholic drinks is sold or supplied for consumption on the premises (other than alcoholic drinks sold or supplied having been made up in advance ready for sale or supply in a securely closed container) it is available to customers in the following measures -
 - (i) beer or cider: 1/2 pint;
 - (ii) gin, rum, vodka or whisky: 25 ml or 35 ml; and
 - (iii) still wine in a glass: 125 ml;
 - (b) these measures are displayed in a menu, price list or other printed material which is available to customers on the premises; and
 - (c) where a customer does not in relation to a sale of alcohol specify the quantity of alcohol to be sold, the customer is made aware that these measures are available.
- 1.7 The responsible person must ensure that staff on relevant premises do not carry out, arrange or participate in any irresponsible promotions in relation to the premises.

In this paragraph, an irresponsible promotion means any one or more of the following activities, or substantially similar activities, carried on for the purpose of encouraging the sale or supply of alcohol for consumption on the premises -

- (a) games or other activities which require or encourage, or are designed to require or encourage, individuals to –
 - (i) drink a quantity of alcohol within a time limit (other than to drink alcohol sold or supplied on the premises before the cessation of the period in which the responsible person is authorised to sell or supply alcohol), or
 - (ii) drink as much alcohol as possible (whether within a time limit or otherwise);
 - (b) provision of unlimited or unspecified quantities of alcohol free or for a fixed or discounted fee to the public or to a group defined by a particular characteristic in a manner which carries a significant risk of undermining a licensing objective;
 - (c) provision of free or discounted alcohol or any other thing as a prize to encourage or reward the purchase and consumption of alcohol over a period of 24 hours or less in a manner which carries a significant risk of undermining a licensing objective;
 - (d) selling or supplying alcohol in association with promotional posters or flyers on, or in the vicinity of, the premises which can reasonably be considered to condone, encourage or glamorise anti-social behaviour or to refer to the effects of drunkenness in any favourable manner;
 - (e) dispensing alcohol directly by one person into the mouth of another (other than where that other person is unable to drink without assistance by reason of disability).
- 1.8 (1) The admission of children to the exhibition of any film is to be restricted in accordance with this section.

APPENDIX C

- (2) Where the film classification body is specified in the licence, unless subsection (3)(b) applies, admission of children must be restricted in accordance with any recommendation made by that body.
- (3) Where:
 - (a) the film classification body is not specified in the licence, or
 - (b) the relevant licensing authority has notified the holder of the licence that this subsection applies to the film in question, admission of children must be restricted in accordance with any recommendation made by that licensing authority.
- (4) In this section:

"children" means persons aged under 18; and

"film classification body" means the person or persons designated as the authority under section 4 of the Video Recordings Act 1984 (c. 39) (authority to determine suitability of video works for classification).

ANNEX 2 - CONDITIONS CONSISTENT WITH THE OPERATING SCHEDULE

The following conditions in Annex 2 are conditions consistent with the operating schedule submitted by the applicant within the application:

- 2.1 All instances of drunkenness, disorder, drug use or violence shall be challenged, resulting in the ejection or retention of the individual(s), where permissible, and under serious circumstances consideration shall be given to their permanent exclusion from the premises in future.
- 2.2 An incident book(s)/refusals register shall be kept and maintained on the premises at all times. The book(s) shall detail all incidents of injury/ejection/refusals/drug misuse/seizure/age challenge. Such matters shall be timed, dated and signed by the author and produced to police or an authorised officer of the licensing authority on demand. In the case of refusals register, there shall be one at each bar area, or any other area utilised for the supply of alcohol.
- 2.3 The premises licence holder or their appointed representative shall ensure that the toilet areas are regularly checked, whilst the premises are open for licensable activities. A 'toilet-check' log sheet shall be endorsed to this effect and made available to police or an authorised officer of the licensing authority immediately upon request. Staff shall be diligent to monitor toilet areas for signs of, and to prevent, drug taking. This may include treating surfaces to reduce their potential for drug use.
- 2.4 The premises licence holder shall adopt a policy to prevent and deter any use of drugs or other banned substances on the licensed premises. Prominent signage shall be displayed and maintained on the licensed premises in relation to this policy.
- 2.5 The premises licence holder shall operate a 'driver's shelf' selection of non-alcoholic beverages, and signage to remind patrons to not drink and drive. Licensed taxi and private hire contact numbers shall be made available to patrons to assist with their departure from the premises.
- 2.6 All fixtures, fittings and equipment used in public areas of the premises shall be regularly inspected and serviced where necessary in order to promote public safety.
- 2.7 Adequate illumination shall be provided to external areas of the licensed premises during the hours of darkness, to promote the prevention of crime and disorder and public safety. All reasonable precautions shall be taken to ensure that the specification and positioning of lighting does cause a nuisance to neighbouring properties.
- 2.8 An accident and incident book shall be maintained at the licensed premises, with all entries to be legibly recorded and checked/signed weekly by the DPS. The book shall be made available upon request of an authorised officer of the Licensing Authority or Police.

APPENDIX C

- 2.9 Adequate provision of first aid materials and trained personnel shall be on duty at the premises during licensable activities, and in accordance with the premises licence holders risk assessment.
- 2.10 Any cooler, condenser or ventilation/extraction systems used at the premises shall be positioned, sound attenuated and operated so as to minimise any risk of public nuisance being caused to neighbouring properties.
- 2.11 Children shall not be permitted in the bar area of the licensed premises unless accompanied by a person aged 18 or over, or else passing through the bar area to attend toilet facilities or the beer garden.
- 2.12 The above condition 11 does not apply for use of the café area of the licensed premises.
- 2.13 There shall be no adult entertainment or services, activities, other entertainment or matters ancillary to the use of the premises that may give rise to concern in respect of children.
- 2.14 The premises licence holder shall adopt a 'Challenge 21' proof of age scheme. The premises licence holder shall operate a requirement for the production of a passport, UK photocard driving licence or PASS accredited photocard, where the individual requesting the supply of alcohol appears to be under the age of 21.

ANNEX 3 - CONDITIONS ATTACHED AFTER A HEARING BY THE LICENSING AUTHORITY

Not Applicable

ANNEX 4 - PLANS

As attached.

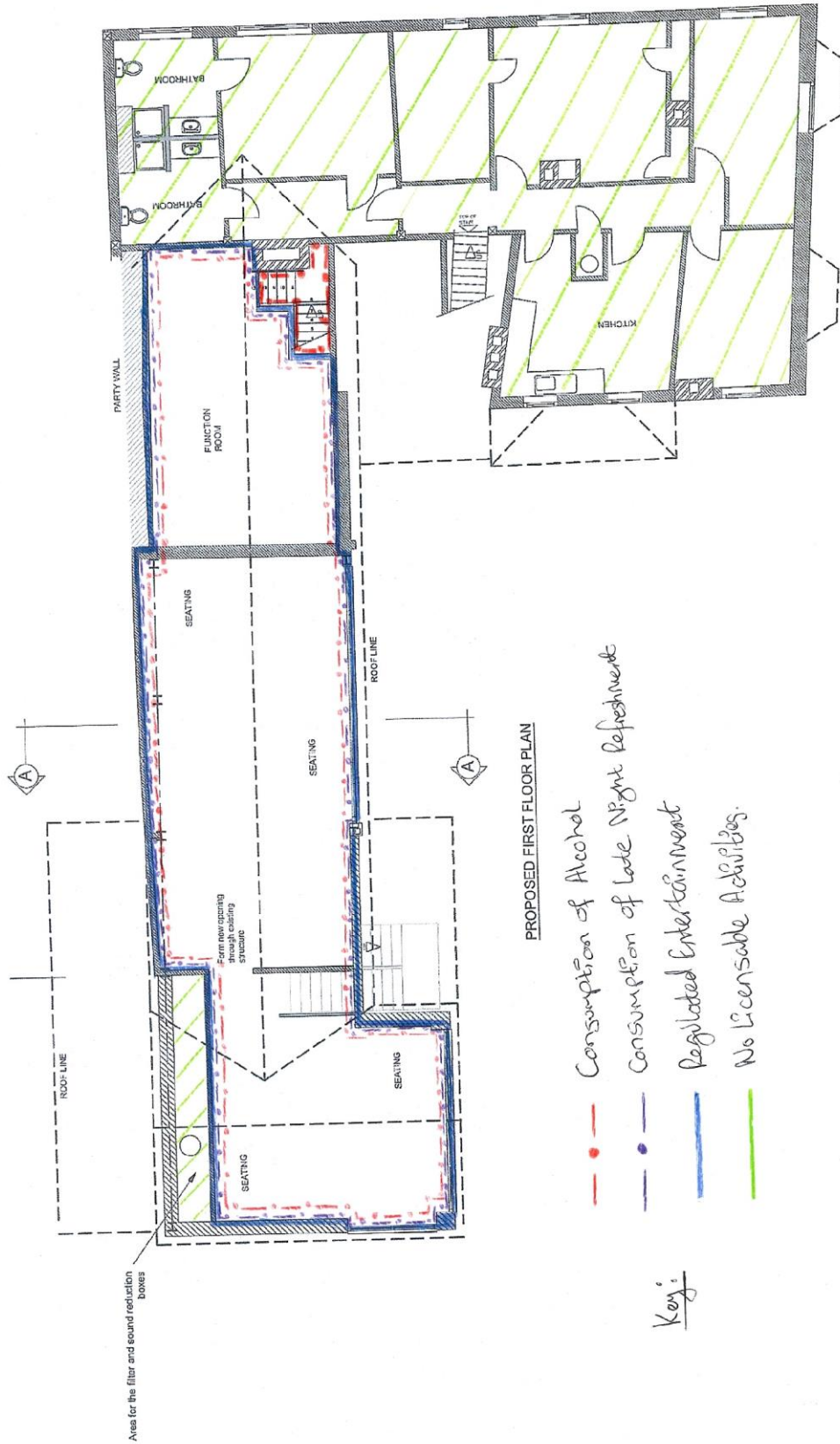

PROPOSED FIRST FLOOR PLAN

- Consumption of Alcohol
- Consumption of Late Night Refreshments
- — Regulated Entertainment
- — No Licensable Activities

Key:

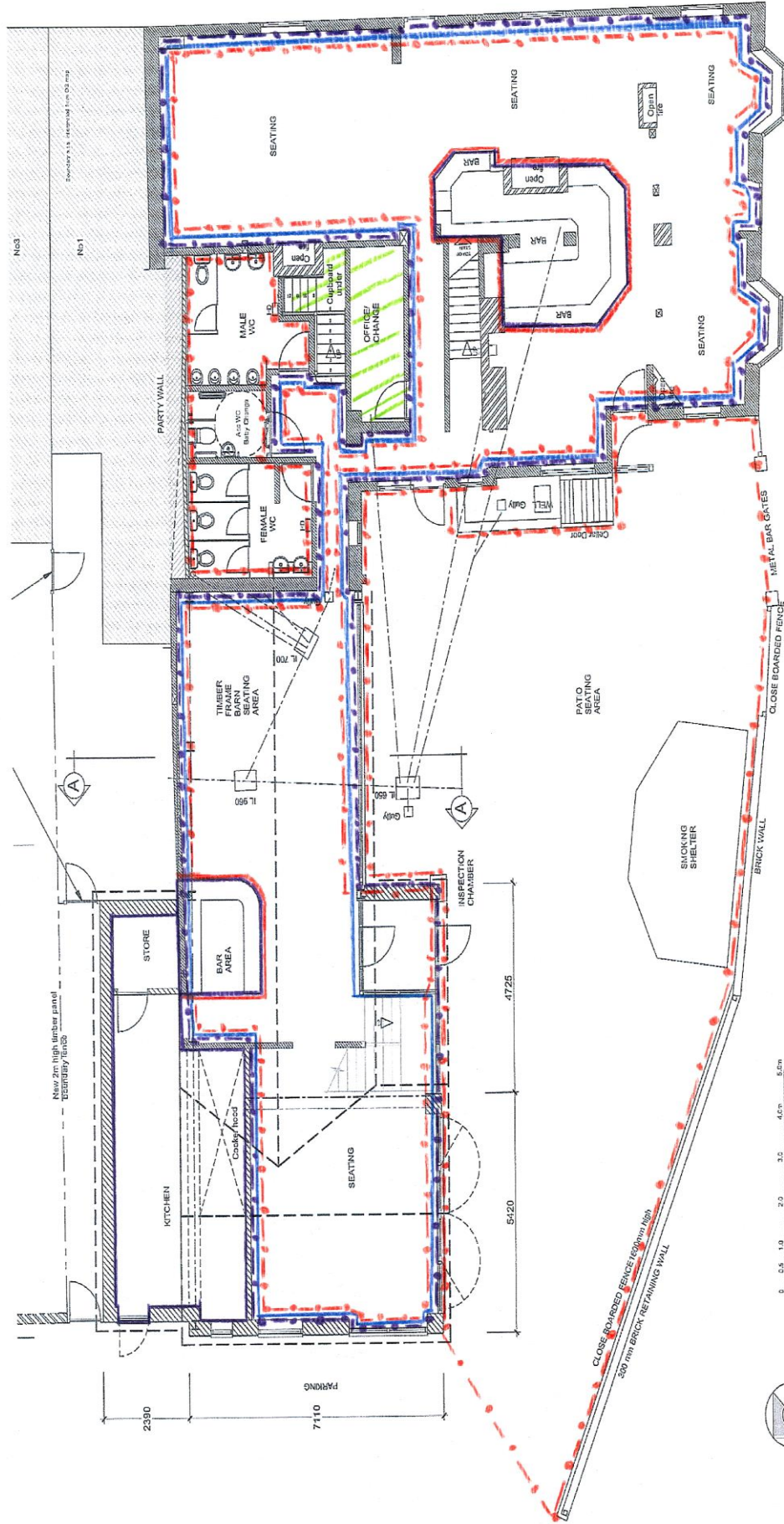

- Key:
- Consumption of Alcohol
 - Sale of Alcohol
 - Regulated Entertainment
 - Consumption of Alcohol
 - Consumption of Late Night Refreshment
 - Late Night Refreshment
 - No Licensable Activities

